



**HARVARD**  
MEDICAL SCHOOL



Beth Israel Deaconess  
Medical Center  
Department of Medicine

TWENTY-THIRD ANNUAL MEETING

# HIV Update

Contemporary Issues in Management

**MAY 30 - JUNE 1, 2019**

Aloft Boston Seaport District  
Boston, Massachusetts, USA



**HEALTH CARE PROFESSIONALS CAN RELY ON THIS PROGRAM FOR THE LATEST UPDATES AND ADVANCES IN THE DIAGNOSIS AND MANAGEMENT OF THE HIV-INFECTED PATIENT**

**OUR EXPERT FACULTY, RECOGNIZED AS LEADERS IN CLINICAL PRACTICE AND MEDICAL EDUCATION, WILL ENRICH YOUR KNOWLEDGE IN ALL FIELDS OF HIV MANAGEMENT. TOPICS INCLUDE:**

- HIV for the primary care provider
- Opportunistic infections
- HIV vaccines
- Perinatal transmission
- PrEP/PEP
- Managing coinfection with HBV or HCV
- Integrating addiction treatment into HIV care
- HPV-related complications
- Adherence to lifelong antiretroviral regimens
- New therapeutic regimens
- Gender and sexual health
- HIV and transplantation
- Management of renal, cardiovascular, and liver diseases

**UNDER THE DIRECTION OF:**

**Peter F. Weller, MD, MACP | Douglas S. Krakower, MD | Simi Padival, MD**

**EARN UP TO:**

18 AMA PRA Category 1 Credits™ | 18 MOC Points | 6.25 Risk Management Credits  
18 Continuing Nurse Education Hours

**REGISTER NOW: [www.HIVupdateBoston.com](http://www.HIVupdateBoston.com)**

# course description

For more than three decades, advances in medical knowledge and biomedical technology have fostered the evolution of HIV clinical care. But with more than 1.1 million people receiving treatment for HIV in the United States, **the HIV epidemic continues to grow more complex, and health care professionals struggle to keep current on the latest developments and regimens.** Along with adherence to lifelong antiretroviral therapy, today's HIV-infected patient may also confront limitations in accessing care, renal, cardiovascular and liver diseases, other illnesses associated with aging, and coinfections with hepatitis B and/or C.

We invite you to advance your knowledge in HIV clinical care by attending this comprehensive CME course integrating all aspects of HIV management and treatment. Key topics include:

- Diagnosing and managing HIV — tools for the primary care provider
- Identifying optimal antiretroviral therapy (ART), treatment initiation, salvage therapy, and pre- and post-exposure prophylaxis and adherence to lifelong therapies
- Integrating HIV management and opioid addiction treatment
- Addressing opportunistic infections, dermatologic conditions, malignancies and hepatitis B and C coinfections
- Examining contemporary HIV topics including aging in the HIV population, renal, cardiovascular and liver diseases; and the management of HPV-related anogenital infection
- Overcoming barriers in HIV for marginalized populations
- Utilizing practical tools to address gender and sexual health challenges, including screening and treatment of sexually transmitted infections

## ENGAGING SESSIONS WITH PROMINENT EXPERTS AND COLLEAGUES

Our outstanding faculty, recognized as experts in the field, will teach you how to incorporate the latest tests and tools into your practice. We will discuss challenging cases and treatments and give you ample opportunity to ask questions of and interact with leading experts. Course material will be presented in a distraction-free environment through formats that include:

- Innovative lectures
- Valuable case-based sessions
- Question-and-answer panels
- Interactive discussions utilizing the Audience Response System

## WHY YOU SHOULD ATTEND

Increase your skills and knowledge to deliver unparalleled care to your patients. You will leave the course with:

- The latest HIV knowledge, insight and teachings from leading authorities and clinical educators
- A greater understanding of incorporating tools and tests into your practice
- Awareness of your strengths and areas for improvement
- A network of like-minded professional colleagues
- An in-depth print and electronic syllabus packed with valuable information and real-world solutions

## WHO SHOULD ATTEND?

Whether you are a recent or an experienced provider of HIV care, this program is designed to educate providers at all levels, including:

- Physicians specializing in infectious diseases, primary care, family practice, internal medicine, hospitalists, geriatrics, gastroenterology and hepatology
- PAs
- Nurse practitioners
- Nurses
- Pharmacists
- Social workers

**HIGHEST-RATED CME**

**THIS PROGRAM IS AMONG THE  
HIGHEST-RATED HARVARD  
MEDICAL SCHOOL CME COURSES.**

# faculty

## COURSE DIRECTORS



### **Peter F. Weller, MD, MACP**

William Bosworth Castle  
Professor of Medicine  
Harvard Medical School  
Professor of Immunology  
and Infectious Diseases  
Harvard T.H. Chan School  
of Public Health  
Chief, Infectious Diseases  
Division  
Chief, Allergy and  
Inflammation Division  
Vice Chair for Research  
Department of Medicine  
Beth Israel Deaconess  
Medical Center



### **Douglas S. Krakower, MD**

Assistant Professor of  
Medicine  
Harvard Medical School  
Staff Physician, Division of  
Infectious Diseases  
Beth Israel Deaconess  
Medical Center



### **Simi Padival, MD**

Instructor in Medicine  
Harvard Medical School  
Staff Physician, Division of  
Infectious Diseases  
Beth Israel Deaconess  
Medical Center

## GUEST FACULTY

### **Katherine Hsu, MD, MPH, FAAP**

Associate Professor of Pediatrics  
Boston University School of Medicine  
Attending Physician, Pediatric Infectious Diseases  
Boston Medical Center  
Medical Director, Division of STD Prevention and  
HIV/AIDS Surveillance  
Massachusetts Department of Public Health

### **Sean Cahill, PhD**

Director of Health Policy Research  
The Fenway Institute

### **Julie Thompson, PA-C**

Medical Director, Transgender Health Program  
Fenway Health

### **Alexander Y. Walley, MD, MSc**

Associate Professor of Medicine  
Boston University School of Medicine  
Director, Addiction Medicine Fellowship Program  
Boston Medical Center  
Clinical Addiction Research and Education Unit  
Boston Medical Center

## HARVARD MEDICAL SCHOOL FACULTY

### **Barbra M. Blair, MD**

Instructor in Medicine

### **Esther E. Freeman, MD, PhD**

Assistant Professor of Dermatology

### **Camilla S. Graham, MD, MPH**

Assistant Professor of Medicine, Part-time

### **Melanie P. Hoenig, MD**

Associate Professor of Medicine

\* Also Associate Professor of Immunology and Infectious Diseases at Harvard T.H. Chan School of Public Health

### **Arthur Y. Kim, MD**

Associate Professor of Medicine

### **Howard Libman, MD**

Professor of Medicine, Emeritus

### **Ami G. Multani, MD**

Instructor in Medicine

### **Ruvandhi Nathavitharana, MBBS, MPH**

Instructor in Medicine

### **Bisola O. Ojikutu, MD, MPH**

Assistant Professor of Medicine

### **Christopher F. Rowley, MD, MPH**

Assistant Professor of Medicine

### **Roger L. Shapiro, MD, MPH**

Associate Professor of Medicine\*

### **Wendy Stead, MD**

Assistant Professor of Medicine

### **Kathryn E. Stephenson, MD, MPH**

Assistant Professor of Medicine

### **Robin Wigmore, MD**

Instructor in Medicine

### **David S. Yassa, MD**

Instructor in Medicine

### **Markella V. Zanni, MD**

Assistant Professor of Medicine

## PLANNING COMMITTEE

### **Allison R. Webel, RN, PhD**

Lead Nurse Planner

Director of Continuing Education

Association of Nurses in AIDS Care

## LEARNING OBJECTIVES

At the end of this course, you will be able to:

1. Evaluate current data and guidelines on post-exposure and pre-exposure prophylaxis to prevent HIV infection
2. Recognize the clinical manifestations of HIV infection and describe recent advances in HIV testing
3. Integrate into practice recent advances in HIV care including tailoring antiretroviral therapy based on genotype, comorbidities and potential drug interactions; appropriate incorporation of newer antiretroviral agents into treatment regimens; approaches to initial treatment and salvage antiretroviral therapy; management of special populations; and appropriate management of common infections, opportunistic and otherwise
4. Counsel HIV-infected patients regarding antiretroviral therapy adherence and potential long-term complications such as the risk for development of specific malignancies, chronic liver or renal disease, and chronic metabolic issues
5. Incorporate treatment approaches to address comorbidities and infectious complications
6. Determine which HIV-infected patients with hepatitis C virus (HCV) infection are candidates for HCV treatment with directly acting antivirals, design regimens and assessments of response, and describe drug-drug interactions, especially in HIV/HCV-coinfected patients on antiretroviral therapy
7. Integrate treatments for substance use disorders into HIV care settings

# registration information

## HIV Update:

### Contemporary Issues in Management

REGISTER ON OR BEFORE  
MARCH 22, 2019, AND SAVE \$100

AFTER MARCH 22, 2019

Physicians and Allied Health Professionals

\$725

\$825

Residents and Fellows in Training

\$525

\$625

Fees shown in USD. Your tuition includes all breakfasts, coffee and refreshment breaks and complimentary Internet access. All attendees will receive a comprehensive printed syllabus with online access.

# general information

## ACCREDITATION

The Harvard Medical School is accredited by the Accreditation Council for Continuing Medical Education (ACCME) to provide continuing medical education for physicians.

The Harvard Medical School designates this live activity for a maximum of 18 *AMA PRA Category 1 Credits*<sup>™</sup>. Physicians should claim only the credit commensurate with the extent of their participation in the activity.

## ABIM MAINTENANCE OF CERTIFICATION

Successful completion of this CME activity enables the participant to earn up to 18 MOC Points in the American Board of Internal Medicine's (ABIM) Maintenance of Certification (MOC) program. Participants will earn MOC Points equivalent to the amount of CME credits claimed for the activity. It is the CME activity provider's responsibility to submit participant completion information to ACCME for the purpose of granting ABIM MOC Points.

## CANADIAN ACCREDITATION

The Royal College of Physicians and Surgeons of Canada recognizes conferences and workshops held outside of Canada that are developed by a university, academy, hospital, specialty society or college as accredited group learning activities.

## EUROPEAN ACCREDITATION

Through an agreement between the American Medical Association and the European Union of Medical Specialists, physicians may convert *AMA PRA Category 1 Credits*<sup>™</sup> to an equivalent number of European CME Credits<sup>®</sup> [ECMECs<sup>®</sup>]. Information on the process of converting *AMA PRA Category 1 Credits*<sup>™</sup> to ECMECs<sup>®</sup> can be found at: [www.eaccme.eu](http://www.eaccme.eu).

PLEASE NOTE THIS COURSE HAS SOLD OUT IN PREVIOUS YEARS. TO ENSURE A SPOT, EARLY REGISTRATION IS STRONGLY RECOMMENDED.

## AAFP

This live activity, *HIV Update: Contemporary Issues in Management*, with a beginning date of 05/30/2019, has been reviewed and is acceptable for up to 18 Prescribed Credits by the American Academy of Family Physicians. Physicians should claim only the credit commensurate with the extent of their participation in the activity.

## RISK MANAGEMENT

This activity meets the criteria of the Massachusetts Board of Registration in Medicine for 6.25 credits of Risk Management Study. This includes 0.75 credits of Opioid Education and Pain Management Training. Please check your individual state licensing board requirements before claiming Risk Management Credits.

## ABMS/ACGME COMPETENCIES

The course is designed to meet the following American Board of Medical Specialties (ABMS)/ Accreditation Council for Graduate Medical Education (ACGME) competencies:

- Patient care and procedural skills
- Medical knowledge
- Practice-based learning and improvement

## IOM COMPETENCIES

The course is designed to meet the following Institute of Medicine (IOM) competencies:

- Provide patient-centered care
- Employ evidence-based practice
- Work in interdisciplinary teams

## NURSING CREDIT



The Association of Nurses in AIDS Care will provide 18 Continuing Nurse Education Hours. The

Association of Nurses in AIDS Care is accredited as a provider of continuing nursing education by the American Nurses Credentialing Center's Commission on Accreditation.

## DISCLOSURE POLICY

Harvard Medical School (HMS) adheres to all ACCME Essential Areas, Standards, and Policies. It is HMS's policy that those who have influenced the content of a CME activity (e.g., planners, faculty, authors, reviewers and others) disclose all relevant financial relationships with commercial entities so that HMS may identify and resolve any conflicts of interest prior to the activity. These disclosures will be provided in the activity materials along with disclosure of any commercial support received for the activity. Additionally, faculty members have been instructed to disclose any limitations of data and unlabeled or investigational uses of products during their presentations.

## PAYMENT, CONFIRMATION AND REFUND POLICY

You may register by credit card (Visa, MasterCard or American Express) or check using Harvard Medical School's secure online registration system at [www.HIVupdateBoston.com](http://www.HIVupdateBoston.com). A nonrefundable processing fee of \$10 (USD) will be assessed per transaction. Upon receipt of your paid registration, an email confirmation from the HMS-DCE office will be sent to you. **Be sure to include an email address that you check frequently.** Your email address is used for critical information, including registration confirmation, evaluation and certificate. **Refund requests must be received by postal mail, email or fax.** Refunds, less an administrative fee of \$100, will be issued for all cancellations received two weeks before the start of the course. No refunds will be issued should cancellation occur less than two weeks before. "No shows" are subject to the full course fee, and no refunds will be issued once the conference has started.

STATE-OF-THE-ART  
CONFERENCE  
FACILITIES IN  
ONE OF BOSTON'S  
PREMIER  
NEIGHBORHOODS



## COURSE LOCATION

All sessions for this activity will be held at:

**Aloft Boston Seaport District**

401-403 D Street

Boston, MA 02210

Tel: 617-530-1600

## ACCOMMODATIONS AND TRAVEL

A limited number of rooms have been reserved until May 8, 2019, at the Aloft Boston Seaport District. Please call 888-625-4988 or 617-530-1600 and specify that you are attending the HMS HIV Update course to receive the reduced group rate of \$249 single/double. Early reservations are encouraged. You can also make your reservation online through the course website. Please do not make non-refundable airline reservations until you have received an email from the HMS office confirming your paid registration.

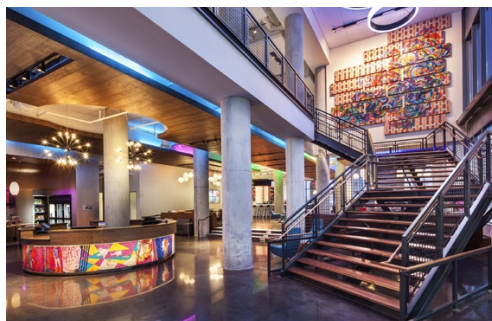

## INQUIRIES

By phone 617-384-8600, Monday-Friday, 9 AM to 5 PM (ET), or by email at [ceprograms@hms.harvard.edu](mailto:ceprograms@hms.harvard.edu).

## DISCLAIMER

CME activities accredited by Harvard Medical School are offered solely for educational purposes and do not constitute any form of certification of competency. Practitioners should always consult additional sources of information and exercise their best professional judgment before making clinical decisions of any kind.

**REGISTER NOW: [www.HIVupdateBoston.com](http://www.HIVupdateBoston.com)**

## THURSDAY, MAY 30, 2019

7:30am – 8:00am

*Registration and Continental Breakfast*

8:00am – 8:15am

**Introduction and Welcome**

*Peter F. Weller, MD, MACP*

8:15am – 8:45am

**History of the HIV Pandemic: Where We Have Been and Where We Are Going**

*Camilla S. Graham, MD, MPH*

8:45am – 9:30am

**HIV for the Primary Care Provider: Meeting the Challenge of Comprehensive Care**

*Robin Wigmore, MD*

9:30am – 9:40am

**Question-and-Answer Session**

*Robin Wigmore, MD*

*Camilla S. Graham, MD, MPH*

9:40am – 10:00am

*Refreshment Break and Stretch*

### PREVENTING HIV TRANSMISSION

10:00am – 10:30am

**HIV Cure: Progress to Date**

*Kathryn E. Stephenson, MD, MPH*

10:30am – 11:00am

**Perinatal Transmission — Best Practices for Care, Prevention and Early Interventions\***

*Roger L. Shapiro, MD, MPH*

11:00am – 11:40am

**Before and After: PrEP and PEP\***

*Douglas S. Krakower, MD*

11:40am – 11:55am

**Question-and-Answer Session**

*Douglas S. Krakower, MD*

*Roger L. Shapiro, MD, MPH*

*Kathryn E. Stephenson, MD, MPH*

11:55am – 1:00pm

*Lunch (on your own)*

### COMPLICATIONS AND COMORBIDITIES

1:00pm – 1:30pm

**Guidelines for the Prevention and Treatment of Opportunistic Infections: Practice Essentials\***

*David S. Yassa, MD*

1:30pm – 2:00pm

**Management of HPV-Related Complications**

*Ami G. Multani, MD*

2:00pm – 2:45pm

**Dermatological Diseases Associated with HIV: Lessons from a Dermatologist**

*Esther E. Freeman, MD, PhD*

2:45pm – 3:00pm

**Question-and-Answer Session**

*David S. Yassa, MD*

*Ami G. Multani, MD*

*Esther E. Freeman, MD, PhD*

3:00pm – 3:20pm

*Refreshment Break and Stretch*

3:20pm – 4:00pm

**Cardiovascular Disease: Prevention Strategies**

*Markella V. Zanni, MD*

4:00pm – 4:40pm

**Renal Manifestations of HIV: Recommendation for Optimal Care**

*Melanie P. Hoenig, MD*

4:40pm – 5:10pm

**HIV Policy: Clinical Implications\***

*Sean Cahill, PhD*

5:10pm – 5:25pm

**Question-and-Answer Session**

*Markella V. Zanni, MD*

*Melanie P. Hoenig, MD*

*Sean Cahill, PhD*

## FRIDAY, MAY 31, 2019

7:30am – 8:00am

*Continental Breakfast*

### HIV ANTIRETROVIRAL THERAPY (ART)

8:00am – 8:45am

**Starting an Initial Antiretroviral Regimen: A Comprehensive Primer**

*Wendy Stead, MD*

8:45am – 9:30am

**New Therapeutic Agents and When to Switch Antiretroviral Regimens**

*Christopher F. Rowley, MD, MPH*

9:30am – 10:15am

**Challenges in HIV Management: Interactive Cases**

*Wendy Stead, MD*

*Christopher F. Rowley, MD, MPH*

10:15am – 10:35am

**Refreshment Break and Stretch**

**VIRAL HEPATITIS WORKSHOP**

10:35am – 11:20am

**Evaluation and Management of Hepatitis B**

*Camilla S. Graham, MD, MPH*

11:20am – 11:55am

**Understanding HIV/HCV Coinfection: Applications for Current and Future Regimens**

*Simi Padival, MD*

11:55am – 1:00pm

**Lunch (on your own)**

1:00pm – 1:30pm

**Management and Diagnosis of Liver Disease**

*Arthur Y. Kim, MD*

1:30pm – 2:30pm

**Managing Coinfection with HBV or HCV: Interactive Cases**

*Camilla S. Graham, MD, MPH*

*Simi Padival, MD*

*Arthur Y. Kim, MD*

2:30pm – 2:50pm

**Refreshment Break and Stretch**

**SEXUAL HEALTH AND HIV**

2:50pm – 3:30pm

**HIV in Marginalized Populations: Improving Outcomes\***

*Bisola O. Ojikutu, MD, MPH*

3:30pm – 4:30pm

**Sexually Transmitted Infections in HIV-Infected and At-Risk Patients: Overcoming Barriers\***

*Katherine Hsu, MD, MPH, FAAP*

4:30pm – 4:45pm

**Question-and-Answer Session**

*Bisola O. Ojikutu, MD, MPH*

*Katherine Hsu, MD, MPH, FAAP*

**SATURDAY, JUNE 1, 2019**

7:30am – 8:00am

**Continental Breakfast**

**COMPLICATIONS AND COMORBIDITIES**

8:00am – 8:30am

**HIV and Transplantation: New Reasons for HOPE\***

*Barbra M. Blair, MD*

8:30am – 9:00am

**TB and HIV Coinfection: A Paradigm for Control and Management**

*Ruvandhi Nathavitharana, MBBS, MPH*

9:00am – 9:10am

**Question-and-Answer Session**

*Barbra M. Blair, MD*

*Ruvandhi Nathavitharana, MBBS, MPH*

9:10am – 9:30am

**Refreshment Break and Stretch**

**SPECIAL POPULATIONS**

9:30am – 10:10am

**Transgender Care: Practical Tools for Providers**

*Julie Thompson, PA-C*

10:10am – 10:50am

**HIV in the Aging Population**

*Howard Libman, MD*

10:50am – 11:30am

**HIV Care in Patients with Opioid Use Disorders\***

*Alexander Y. Walley, MD, MSc*

11:30am – 11:45am

**Question-and-Answer Session**

*Julie Thompson, PA-C*

*Howard Libman, MD*

*Alexander Y. Walley, MD, MSc*

11:45am – 12:00pm

**Closing Remarks**

Please note: Program changes/substitutions may be made without notice. \*Qualifies for Risk Management Credits

**REGISTER NOW: [www.HIVupdateBoston.com](http://www.HIVupdateBoston.com)**



# HARVARD MEDICAL SCHOOL

Department of Continuing Education  
P.O. Box 825  
Boston, MA 02117-0825

Non Profit Org.  
U.S. Postage  
**PAID**  
Holliston, MA  
Permit No. 72

Register at [www.HIVupdateBoston.com](http://www.HIVupdateBoston.com)

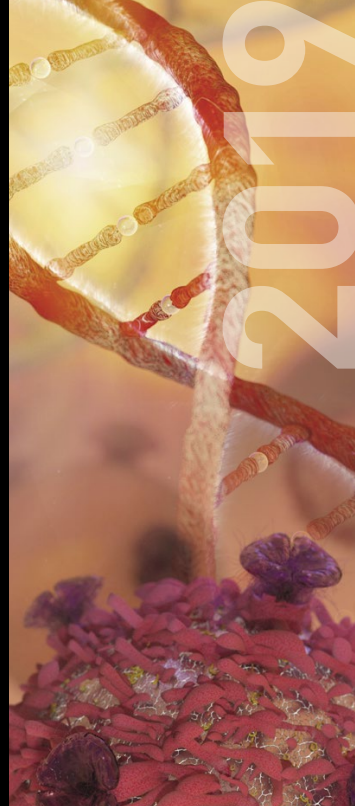

TWENTY-THIRD ANNUAL MEETING

# HIVUpdate

Contemporary Issues in Management

**MAY 30 - JUNE 1, 2019**  
**REGISTER TODAY!**

ALOFT BOSTON SEAPORT DISTRICT  
BOSTON, MASSACHUSETTS, USA

